

# Building Sketch

|                                   |             |        |       |    |                |
|-----------------------------------|-------------|--------|-------|----|----------------|
| Borrower                          |             |        |       |    |                |
| Property Address 400 LEACROFT WAY |             |        |       |    |                |
| City                              | MORRISVILLE | County | State | NC | Zip Code 27560 |
| Lender/Client CRAIG REALTY GROUP  |             |        |       |    |                |

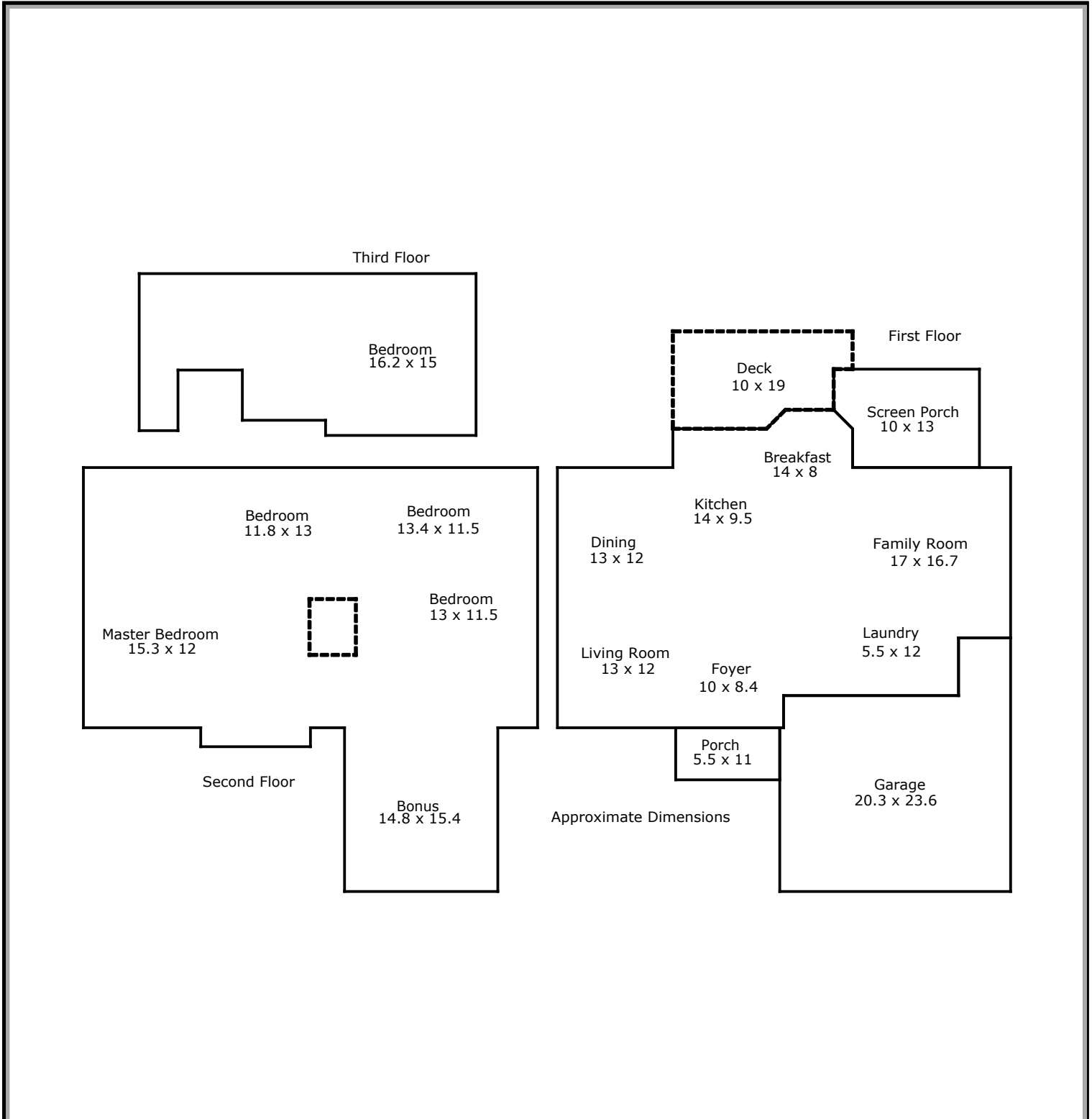

TOTAL Sketch by a la mode, inc.

### Area Calculations Summary

**Living Area**

|                                     |                   |
|-------------------------------------|-------------------|
| First Floor                         | 1294.2 Sq ft      |
| Second Floor                        | 1623.46 Sq ft     |
| Third Floor                         | 545.71 Sq ft      |
| Open to Below                       | -28.91 Sq ft      |
| <b>Total Living Area (Rounded):</b> | <b>3434 Sq ft</b> |

**Non-living Area**

|                |              |
|----------------|--------------|
| 2 Car Attached | 537.27 Sq ft |
| Open Porch     | 60.5 Sq ft   |
| Wood Deck      | 170.9 Sq ft  |
| Screened Porch | 149.96 Sq ft |